

# D R INDIA

Textile Hub

A Project by



Developer of D R World Mall & Multiplex

## Past Projects



**D. R. World Mall & Multiplex**  
Aai Mata Road



**Model Town Regency**  
Saroli



**Model Town Park**  
Puna Kumbharia Road



**Shakti Nagar**  
Parvat Patia



**Vasant Vihar Township**  
Udhana-Magdalla Road



**Abhinandan AC Market**  
Ghoddod Road



**Mangaldeep Apartment**  
Bhatar Road



**Model Township**  
Parvat Patia



D. R. Group is a Business Conglomerate based in the Textile & Diamond city of Surat. We have a leading presence in several Industries such as Real Estate Development, Textiles, Finance & others. In a period of over 40 years D. R. Group has given Surat some of its land mark projects. We have always given priority to better planning, quality of construction & aesthetic beauty of our projects along with considering the requirement of our customers.

Our latest offering is a Textile Hub, which, needless to say, will be yet another addition to our list of exclusive land mark projects. It has come up at one of the city's most prime & up-coming Textile area, Parvat Patiya, which already enjoys the presence of some of the exclusive & famed projects like "D. R. World Mall & Multiplex" (The 1st & Only in this Area) & also " Amazia Amusement Park" (India's One of the Best & Huge Amusement Park Following the likes of "Imagica")





DR INDIA

New Store

skyler

Fashion Street





# Welcome to D R India

a work space with Shine, Style, & Savor

D. R. India will be a centre for the start-ups as well as the ones who dream to expand their enterprises in Surat with high class office spaces, shops & showrooms in Textile industry that's safe, secure and well managed.

**D. R. India is closest to the Old Textile Area. i.e. "Ring Road"**

D. R. India will be a quality commercial space that will encourage and strengthen the economic growth of the city.... Surat.

Open to Sky Cafeteria

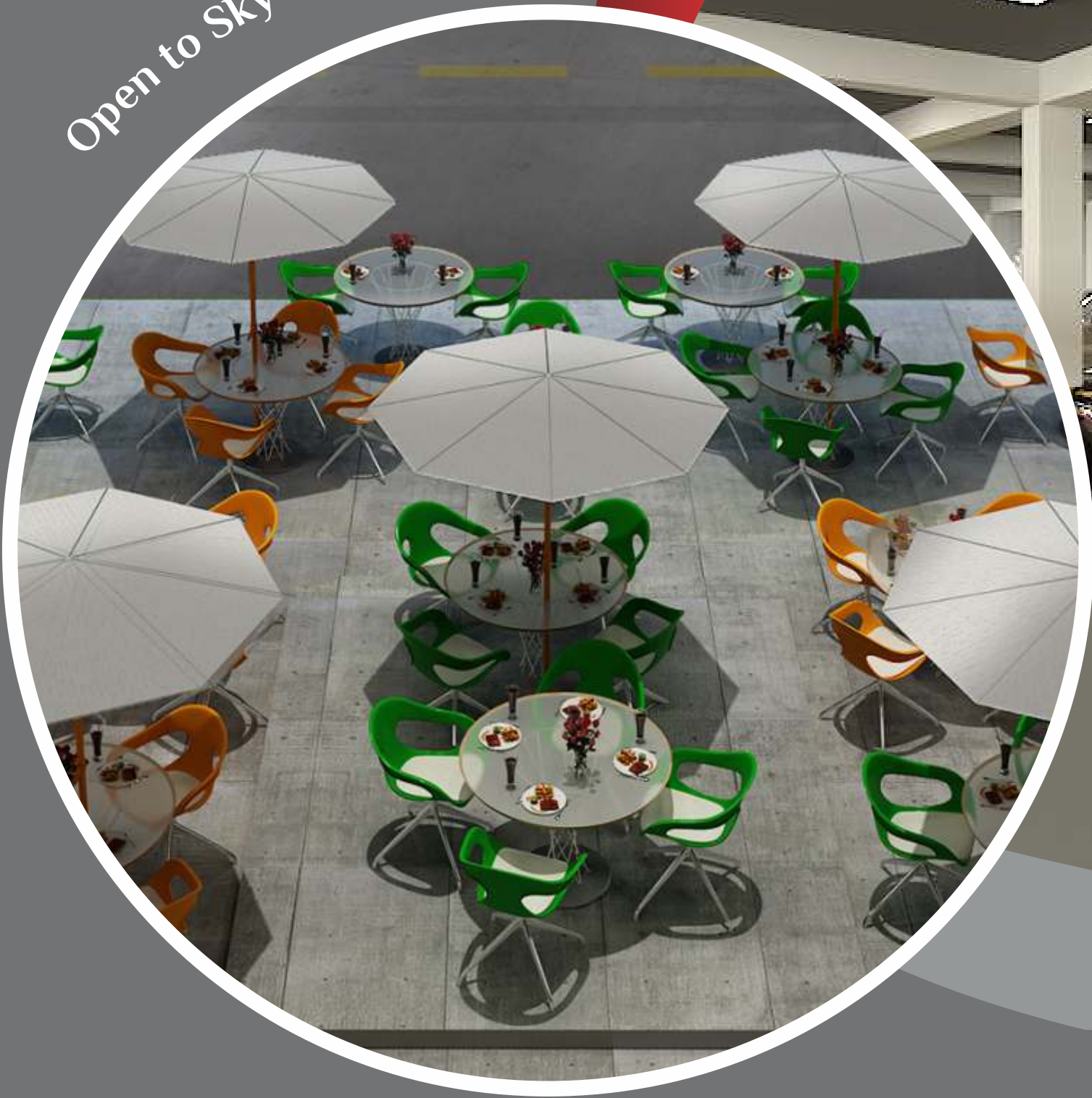





Double Height (16') Basement Parking



DR INDIA

New Skyler

VINE





Elite High Class Elevation





Stunning Entrance Foyer



# Ground Floor Plan

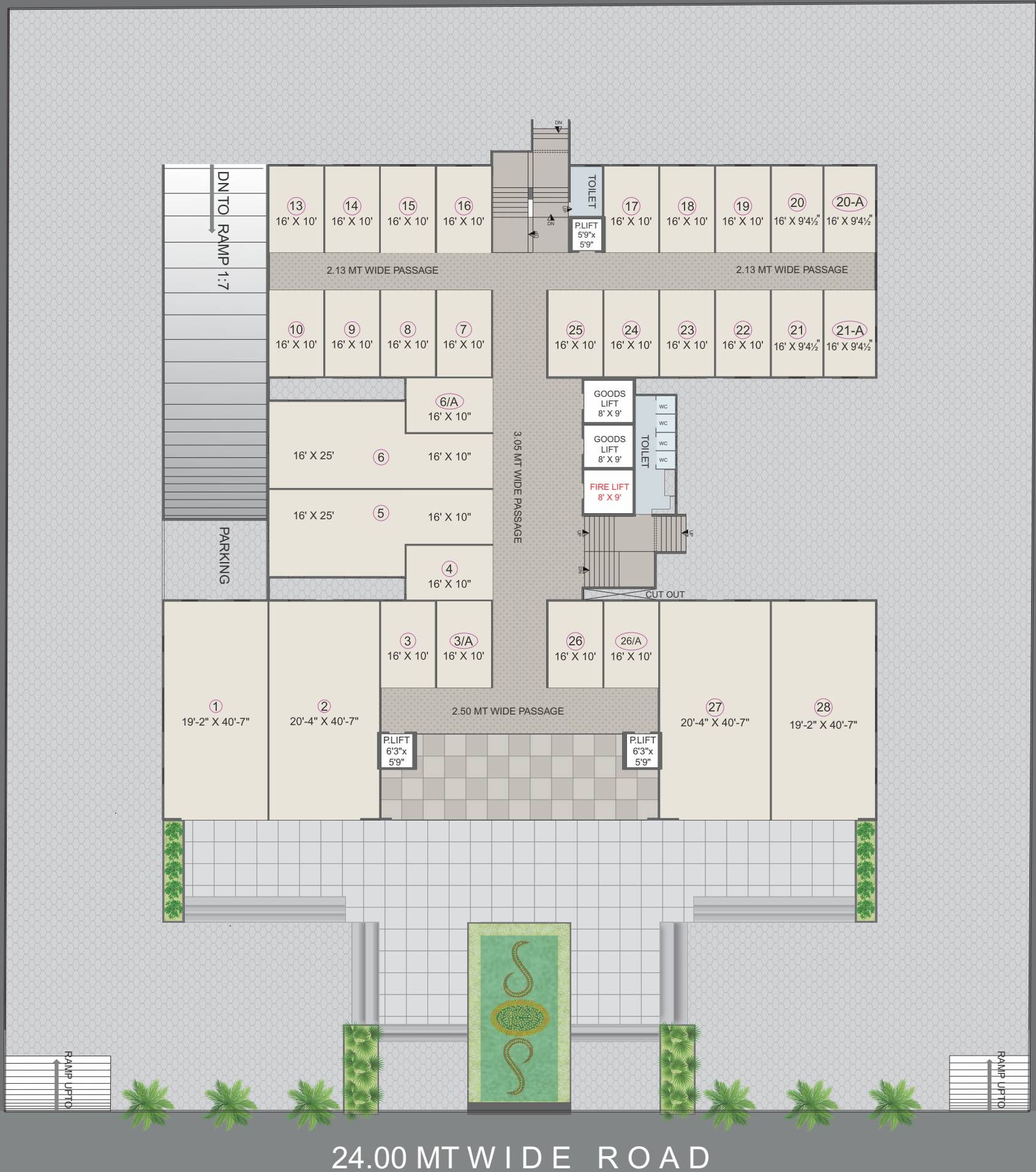

# Typical Floor Plan

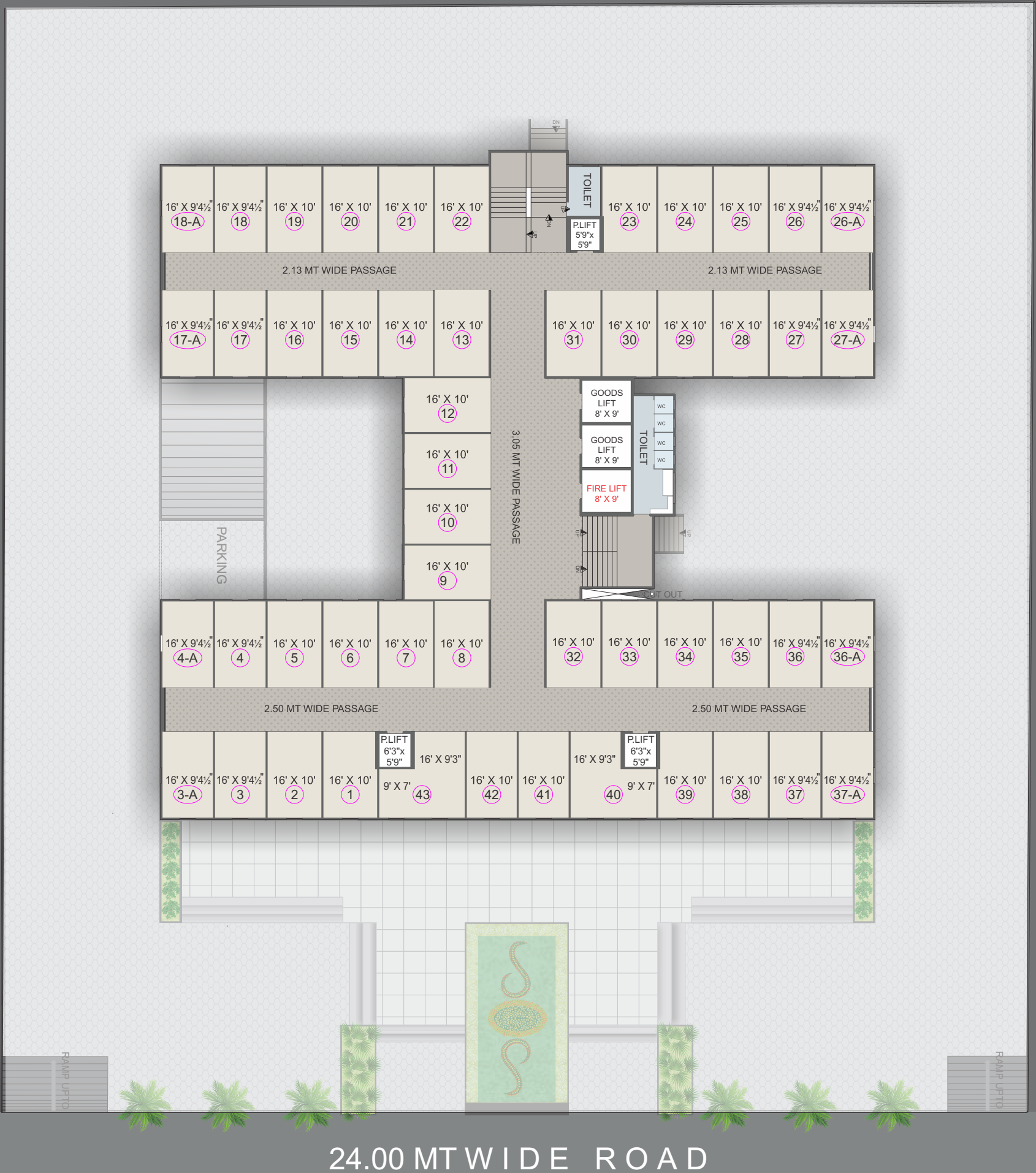

24.00 MT WIDE ROAD







16 Feet High & Spacious Common Passages

Shop With Double Floor Height





# Upper Basement Floor Plan

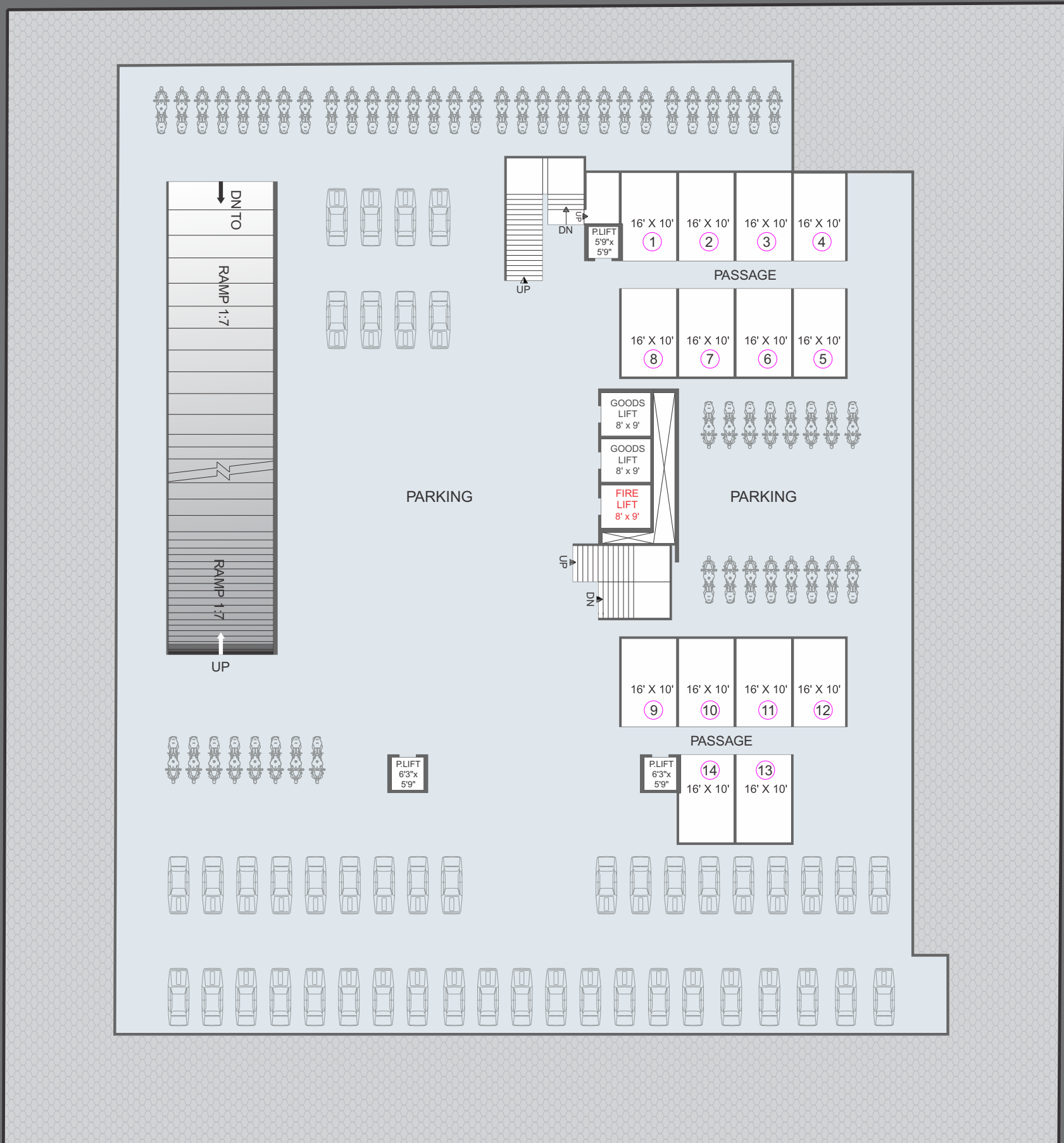

# Lower Basement Floor Plan

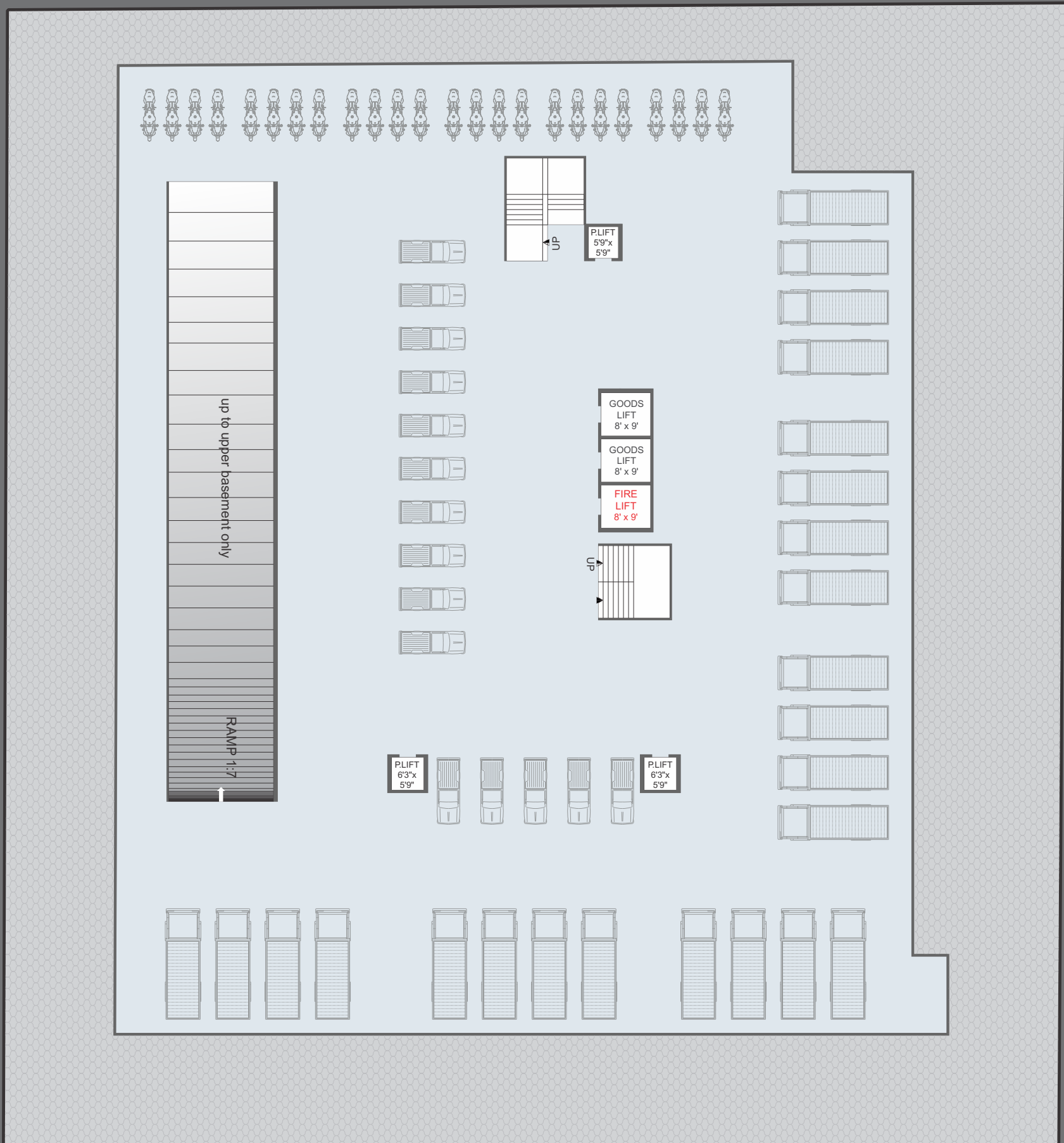





## Amenities

- Double Height Floor (16'4")
- Ample Goods Lifts as Well as Passenger Lifts
- CCTV Camera to Keep a Constant Watch in the Whole of Campus
- Three Layers of Parking
- Dedicated Double Height Basement for Tempo Parking for Loading & Unloading of Goods
- Elite Design & Exclusive Elevation
- Open to Sky Cafeteria
- Advance Fire Safety System
- Security Cabin at The Entry
- Large Spacious Internal Passage of 16 Feet Height Through out The Building
- Free Wi-Fi Zone
- Torrent Electric Power Supply



## Legal Information

- Title clear - Loanable
- N.A. & Plan Pass Permission
- RCC structure Stability Certificate.
- Registered Sale Deed for Individual Members.
- Building Use Certificate
- Lift License



Near by...



In Short, located in the heart of the Surat City's newly Up-coming & Developing Textile Area.





Beautifully Landscaped Work Place

Note : Images are only for graphics purpose, not related to actual.





**Disclaimer :** 1) Stamp duty, registration charges, legal charges, GEB & SMC charges & taxes, society maintenance charges & safety grill expenses etc. Shall be borne by the purchaser. VAT, SERVICE TAX Etc. Will be borne by the purchaser. 2) In the interest of continuous developments in design & quality of construction, the developer reserves all rights to make any changes in the scheme including technical specification, designs, planning, layout & purchaser shall abide by such changes. 3) This brochure is intended only for easy display & information of the scheme & does not form part of any legal document.

### Booking & Site Address

"D R India", Opp. Shubham Residency,  
Archana School Road, B/h. Raghuvir Business Empire,  
Nr. D.R. World, Parvat Patiya, Surat.

email:info@drconstructions.com, drconstructions.77@gmail.com  
www.drconstructions.com



### Developer



### Contact

+91 82380 83293  
+91 98251 14443  
+91 98795 41775

### Architect



### Structural Eng.



**Hemant Shukla**





Believes In Truth



Scan me for more details

[www.drconstructions.com](http://www.drconstructions.com)